



UNLIMITED  
WORKSHOP  
HARDWARE

THINK.CONNECT.BUILD



#### JNF UNLIMITED WORKSHOP HARDWARE

SISTEMA MODULAR PARA CRIAR ESTRUTURAS SIMPLES, COMO MOBILIÁRIO, ELEMENTOS DECORATIVOS, DIVISÓRIAS ESTRUTURAIS, ETC.

OS ELEMENTOS SÃO PRODUZIDOS EM AÇO INOXIDÁVEL AISI 304 POR FUNDIÇÃO, O ACABAMENTO É RAW, OBTENDO UM ASPETO MATE E UMA SENSAÇÃO SUAVE AO TOQUE. ADICIONALMENTE, ESTES COMPONENTES PODEM SER PRODUZIDOS COM ACABAMENTO PVD EM DIFERENTES CORES COMO PRETO, COBRE OU DOURADO.

O SISTEMA DE FIXAÇÃO É MUITO FÁCIL, APENAS COM PARAFUSOS ALLEN QUE GARANTEM O APERTO NECESSÁRIO DE TODOS OS ELEMENTOS.

**THINK - CONNECT - BUILD**

#### JNF UNLIMITED WORKSHOP HARDWARE

MODULAR SYSTEM TO CREATE EASY STRUCTURES LIKE FURNITURE, DECORATIVE ELEMENTS, STRUCTURAL FENCES, ETC.

THE ELEMENTS ARE PRODUCED IN STAINLESS STEEL AISI 304 BY CASTING, THE FINISH IS RAW GETTING A MATTE LOOK AND SMOOTH TOUCH FEELING. ADDITIONALLY THIS COMPONENTS CAN BE PRODUCED WITH PVD FINISH IN DIFFERENT COLORS LIKE DEEP BLACK, COPPER OR GOLD.

THE FIXING SYSTEM IS VERY EASY, JUST ALLEN SCREWS MAKE THE NECESSARY TIGHTENING OF ALL ELEMENTS.

**THINK - CONNECT - BUILD**

#### JNF UNLIMITED WORKSHOP HARDWARE

SISTEMA MODULAR PARA CONSTRUIR ESTRUTURAS SIMPLES, COMO MOBILIÁRIO, ELEMENTOS DECORATIVOS, DIVISIONES ESTRUCTURALES, ETC.

LOS ELEMENTOS SON PRODUCIDOS EN ACERO INOXIDABLE AISI 304 POR FUNDICIÓN, EL ACABADO ES RAW OBTENIENDO UN ASPECTO MATE Y UNA SENSACIÓN SUAVE AL TOQUE. ADEMÁS, ESTOS COMPONENTES SE PUEDEN PRODUCIR CON ACABADO PVD EN DIFERENTES COLORES COMO NEGRO PROFUNDO, COBRE O DORADO.

EL SISTEMA DE FIJACIÓN ES MUY FÁCIL, SÓLO TORNILLOS ALLEN HACEN EL APRIETE NECESARIO DE TODOS LOS ELEMENTOS

**THINK - CONNECT - BUILD**









08

RAW  
RAW / RAW



www.jnf.pt

**RAW**  
RAW / RAW

**IN.09.001**  
Material: EN 1.4301  
Curva / Elbow / Curva  
RAW

11,10€

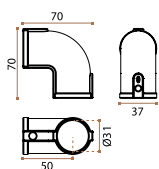

**IN.09.002**  
Material: EN 1.4301  
União / Union / Unión  
RAW

10€

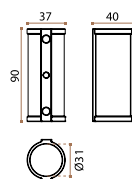

**IN.09.003**  
Material: EN 1.4301  
Conector / Connector / Conector  
RAW

7€

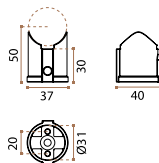

**IN.09.004**  
Material: EN 1.4301  
Base / Base / Base  
RAW

8€

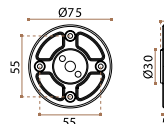



**IN.09.005.1**

**Material: EN 1.4301**

**Conector / Connector / Conector**  
RAW

7,50€

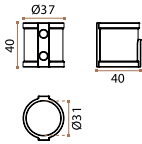

- IN.23.600.30.2000 (30€)**
- IN.23.600.30.3000 (45€)**
- IN.23.600.30.1000.TB (25€)**
- IN.23.600.30.1000.TCO (25€)**
- IN.23.600.30.1000.TG (25€)**

**Material: EN 1.4301**  
Satinado / Satin / Satin

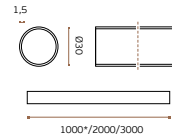

**IN.09.006**

**Material: Aluminum**

**Base interior de fixação / Inner fixing base /**  
Base interior de fijación IN.09.004

6€

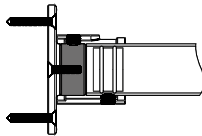

**IN.09.007**

**Material: Aluminum**

**Base interior de fixação / Inner fixing base /**  
Base interior de fijación

6€

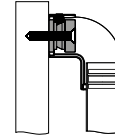

**IN.09.008**

**Material: Aluminum**

**Reforço interior de tubo / Inner tube**  
reinforcement / Refuerzo interior de tubo

8€

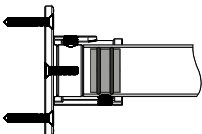

**IN.09.004.1**

**Material: EN 1.4301**

**Tampa de remate / Finishing cap /**  
Cubierta de remate RAW

8€

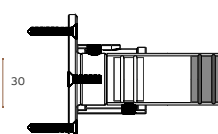







**TITANIUM BLACK (TB)**  
*Titânio Negro / Titânio Negro*



**TITANIUM BLACK (TB)**  
Titânio Negro / Titânio Negro

**IN.09.001.TB**  
Material: EN 1.4301  
Curva / Elbow / Curva  
RAW

16,60€

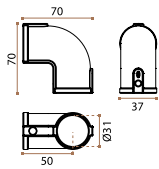

**IN.09.002.TB**  
Material: EN 1.4301  
União / Union / Unión  
RAW

15€

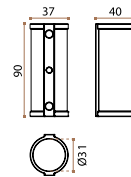

**IN.09.003.TB**  
Material: EN 1.4301  
Conector / Connector / Conector  
RAW

10,50€

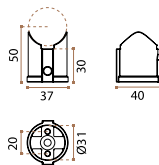

**IN.09.004.TB**  
Material: EN 1.4301  
Base / Base / Base  
RAW

12€

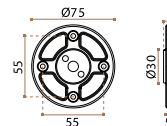



**IN.09.005.1.TB**  
Material: EN 1.4301  
Conector / Connector / Conector  
RAW

11,50€

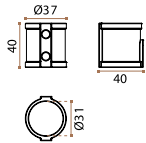

**IN.23.600.30.2000 (30€)**  
**IN.23.600.30.3000 (45€)**  
**IN.23.600.30.1000.TB (25€)**  
**IN.23.600.30.1000.TCO (25€)**  
**IN.23.600.30.1000.TG (25€)**

Material: EN 1.4301  
Satinado / Satin / Satin

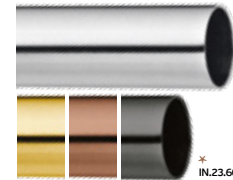
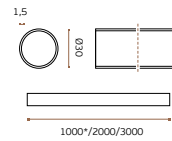

\* IN.23.600.30.1000.TB

**IN.09.006**  
Material: Aluminum  
Base interior de fixação / Inner fixing base /  
Base interior de fijación IN.09.004

6€

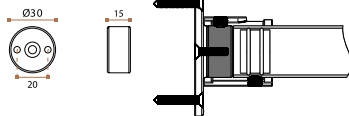

**IN.09.007**  
Material: Aluminum  
Base interior de fixação / Inner fixing base /  
Base interior de fijación

6€

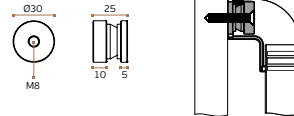

**IN.09.008**  
Material: Aluminum  
Reforço interior de tubo / Inner tube  
reinforcement / Refuerzo interior de tubo

8€

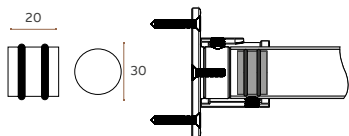

**IN.09.004.1.TB**  
Material: EN 1.4301  
Tampa de remate / Finishing cap /  
Cubierta de remate RAW

12€

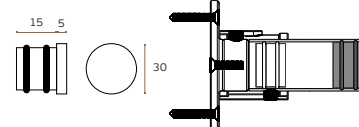





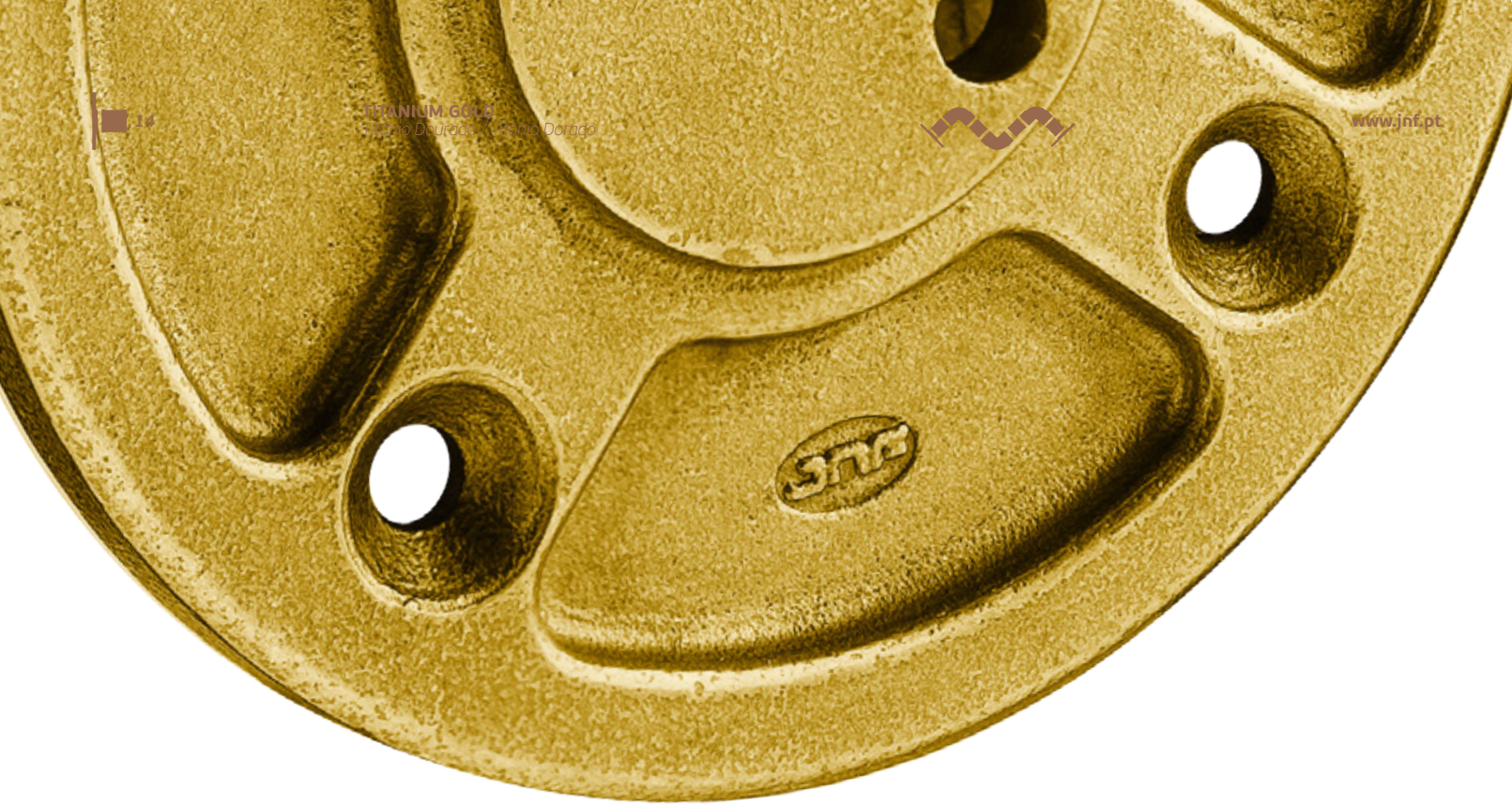

**TITANIUM GOLD (TG)**  
Titânio Dourado / Titanio Dorado

**IN.09.001.TG**  
Material: EN 1.4301  
Curva / Elbow / Curva  
RAW

16,60€

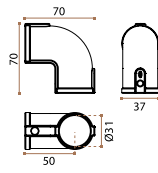

**IN.09.002.TG**  
Material: EN 1.4301  
União / Union / Unión  
RAW

15€

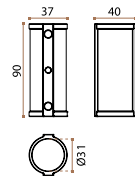

**IN.09.003.TG**  
Material: EN 1.4301  
Conector / Connector / Conector  
RAW

10,50€

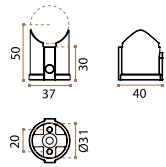

**IN.09.004.TG**  
Material: EN 1.4301  
Base / Base / Base  
RAW

12€

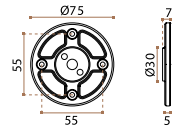



**IN.09.005.1.TG**  
Material: EN 1.4301  
Conector / Connector / Conector  
RAW

11,50€

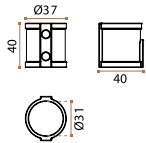

**IN.23.600.30.2000 (30€)**  
**IN.23.600.30.3000 (45€)**  
**IN.23.600.30.1000.TB (25€)**  
**IN.23.600.30.1000.TCO (25€)**  
**IN.23.600.30.1000.TG (25€)**

Material: EN 1.4301  
Satinado / Satin / Satin

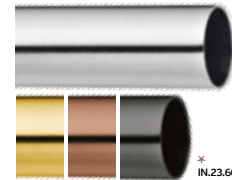
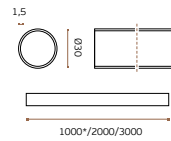

\* IN.23.600.30.1000.TG

**IN.09.006**  
Material: Aluminum  
Base interior de fixação / Inner fixing base /  
Base interior de fijación IN.09.004

6€

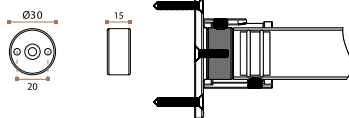

**IN.09.007**  
Material: Aluminum  
Base interior de fixação / Inner fixing base /  
Base interior de fijación

6€

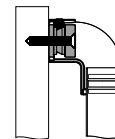
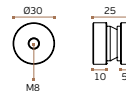

**IN.09.008**  
Material: Aluminum  
Reforço interior de tubo / Inner tube  
reinforcement / Refuerzo interior de tubo

8€

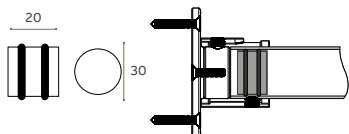

**IN.09.004.1.TG**  
Material: EN 1.4301  
Tampa de remate / Finishing cap /  
Cubierta de remate RAW

12€

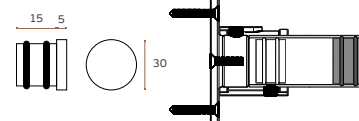







**TITANIUM COPPER (TCO)**  
*Titânio Cobre / Titanio Cobre*





**TITANIUM COPPER (TCO)**  
Titânio Cobre / Titânio Cobre

**IN.09.001.TCO**  
Material: EN 1.4301  
Curva / Elbow / Curva  
RAW

16,60€

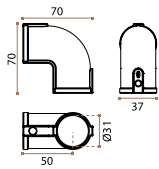

**IN.09.002.TCO**  
Material: EN 1.4301  
União / Union / Unión  
RAW

15€

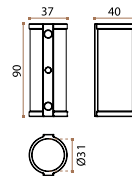

**IN.09.003.TCO**  
Material: EN 1.4301  
Conector / Connector / Conector  
RAW

10,50€

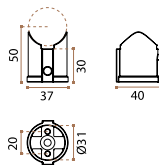

**IN.09.004.TCO**  
Material: EN 1.4301  
Base / Base / Base  
RAW

12€

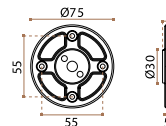



**IN.09.005.1.TCO**

**Material: EN 1.4301**

**Conector / Connector / Conector**  
RAW

11,50€

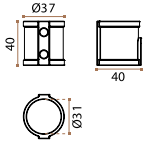

**IN.23.600.30.2000 (30€)**

**IN.23.600.30.3000 (45€)**

**IN.23.600.30.1000.TB (25€)**

**IN.23.600.30.1000.TCO (25€)**

**IN.23.600.30.1000.TG (25€)**

**Material: EN 1.4301**  
Satinado / Satin / Satin

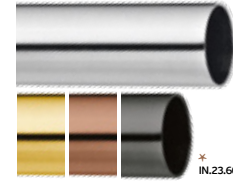
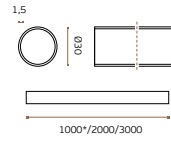

\* IN.23.600.30.1000.TCO

**IN.09.006**

**Material: Aluminum**

**Base interior de fixação / Inner fixing base /**  
Base interior de fijación IN.09.004

6€

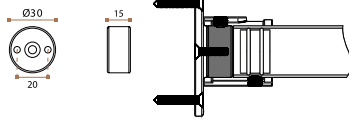

**IN.09.007**

**Material: Aluminum**

**Base interior de fixação / Inner fixing base /**  
Base interior de fijación

6€

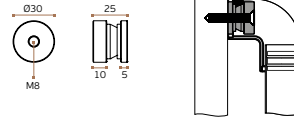

**IN.09.008**

**Material: Aluminum**

**Reforço interior de tubo / Inner tube**  
reinforcement / Refuerzo interior de tubo

8€

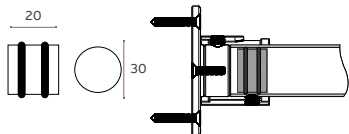

**IN.09.004.1.TCO**

**Material: EN 1.4301**

**Tampa de remate / Finishing cap /**  
Cubierta de remate RAW

12€

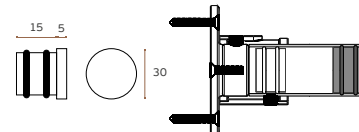

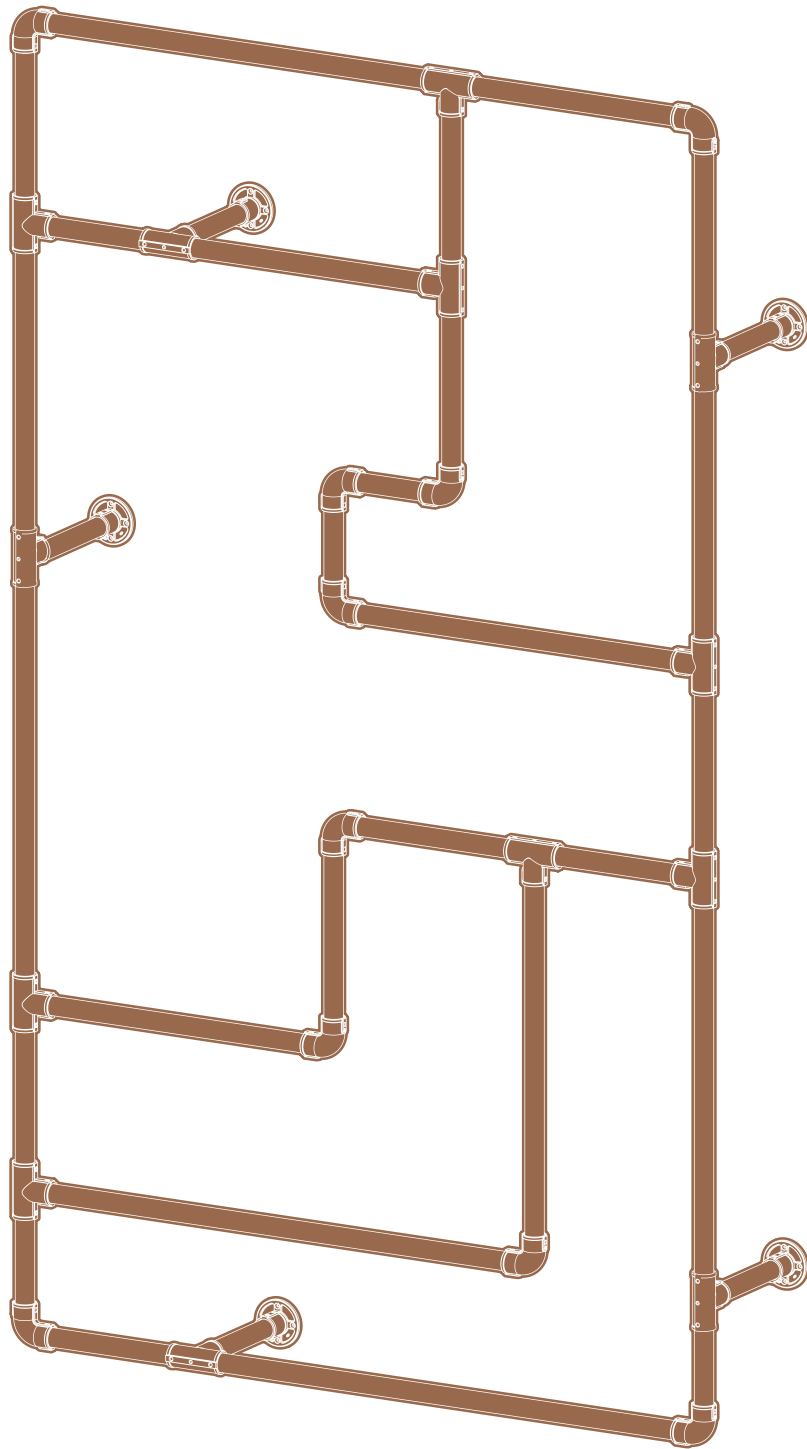

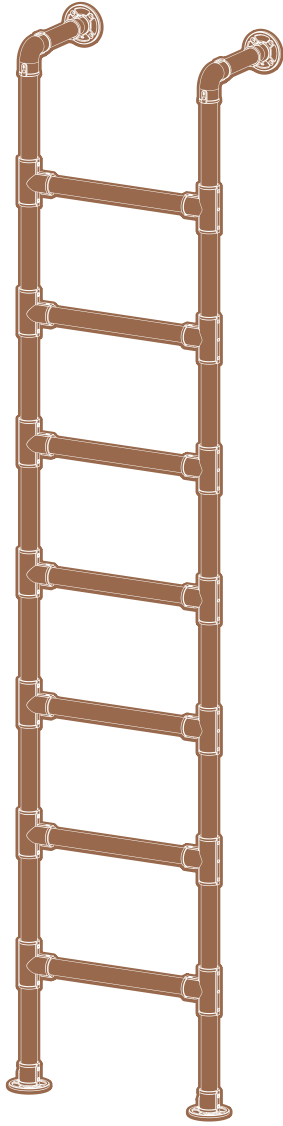

**THINK.CONNECT.BUILD.**

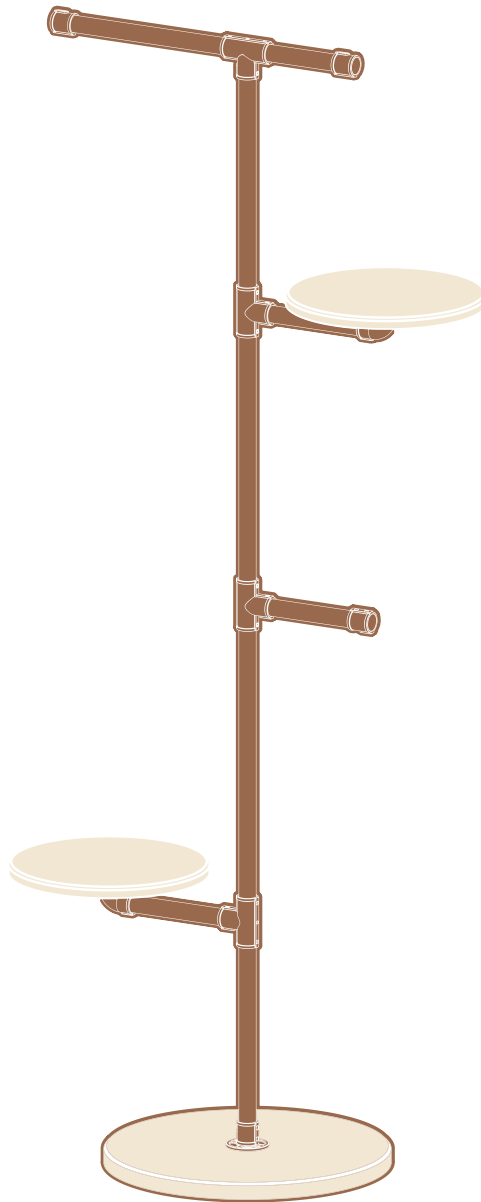

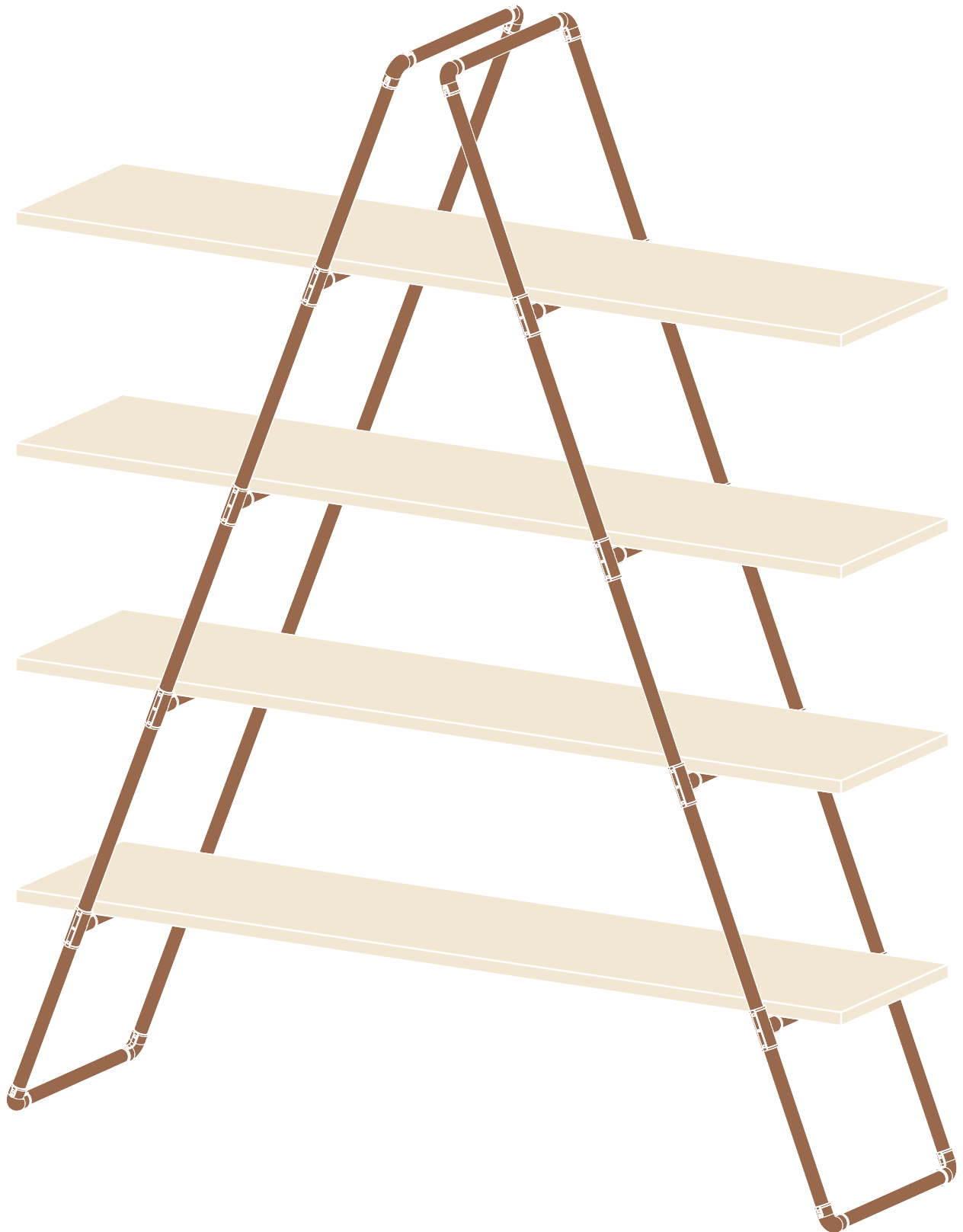

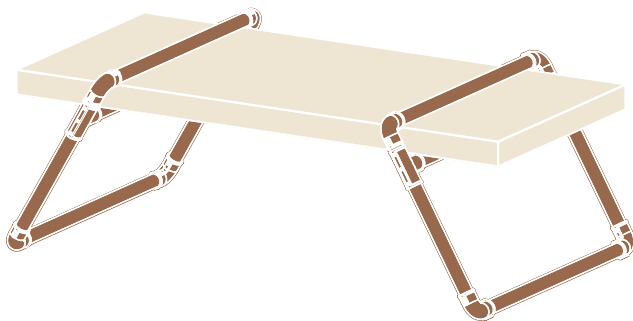
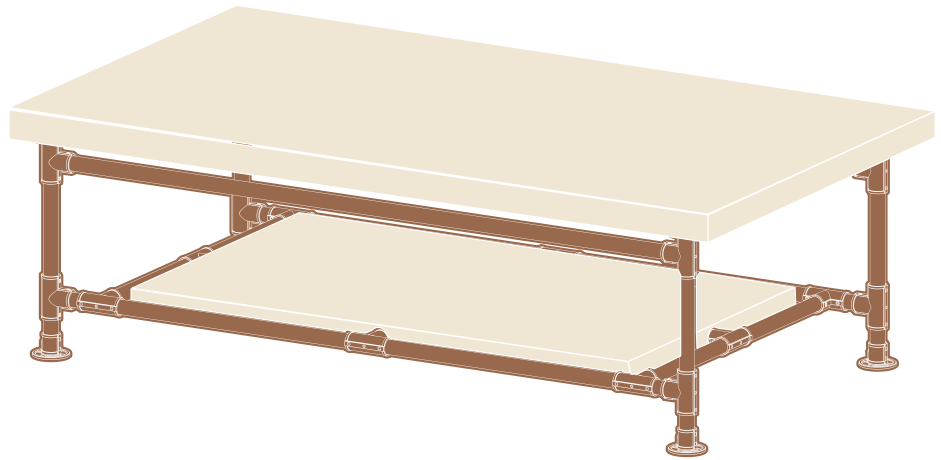

**THINK.CONNECT.BUILD.**

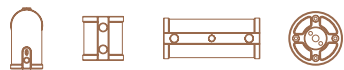

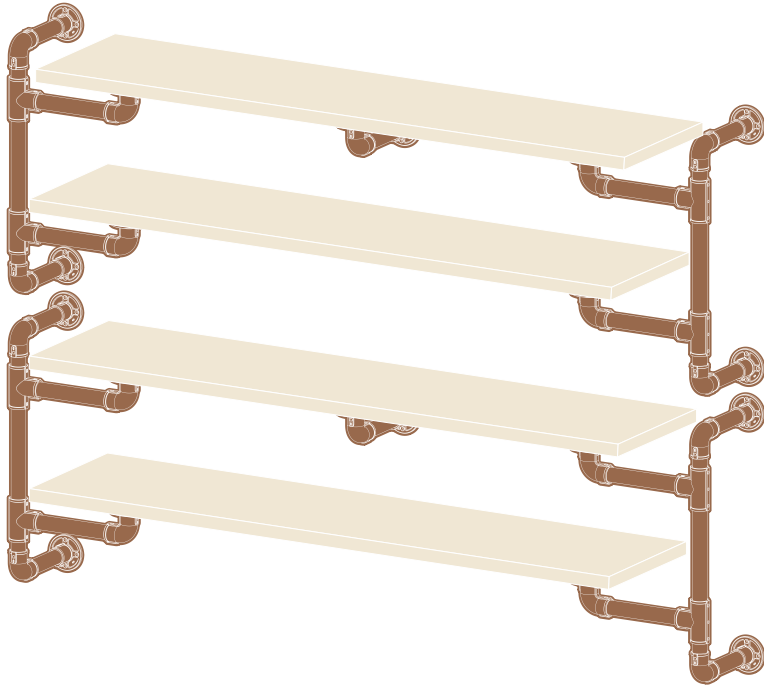

**THINK.CONNECT.BUILD.**

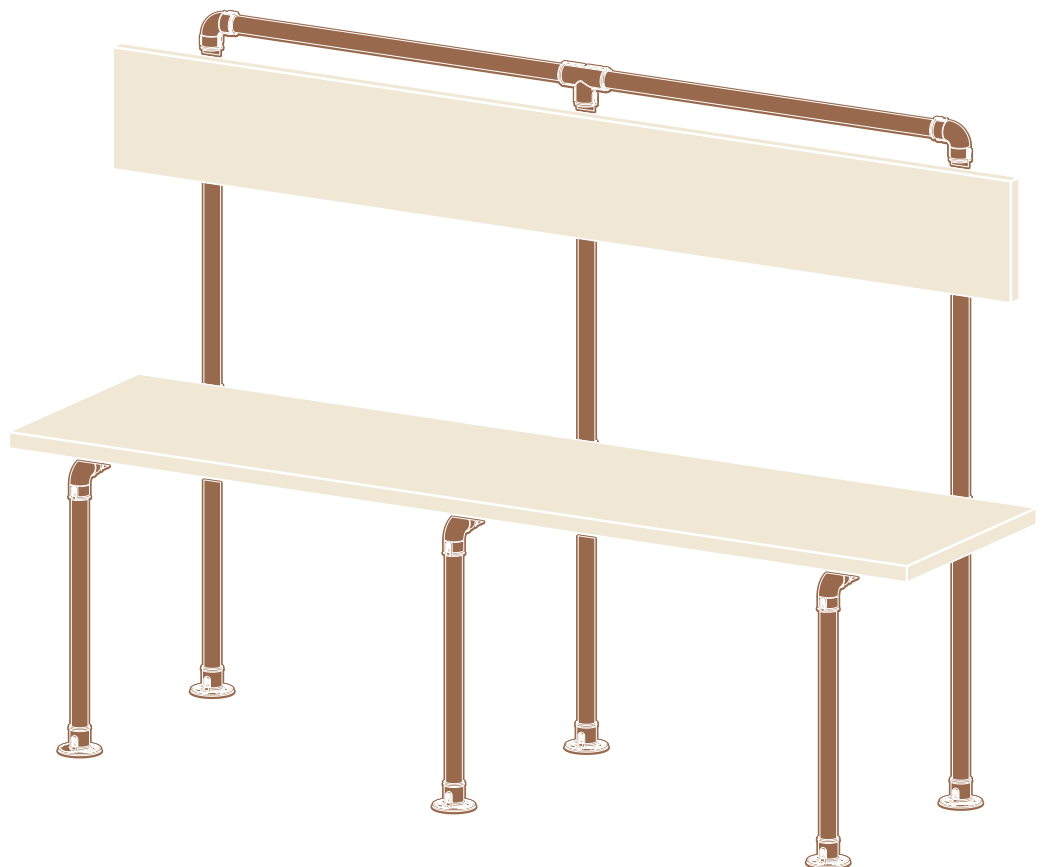





**IN.09.002 / TB / TCO / TG**  
**IN.09.003 / TB / TCO / TG**  
**IN.09.004 / TB / TCO / TG**  
**IN.09.006**  
Material: EN 1.4301



**IN.09.001 / TB / TCO / TG**  
**IN.09.004 / TB / TCO / TG**  
**IN.09.006**  
Material: EN 1.4301



**IN.09.004 / TB / TCO / TG**  
**IN.09.005.1 / TB / TCO / TG**  
**IN.09.006**  
Material: EN 1.4301



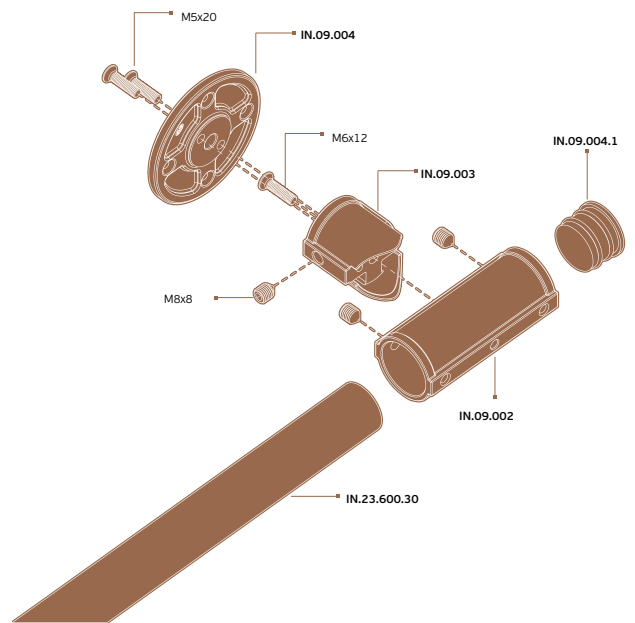
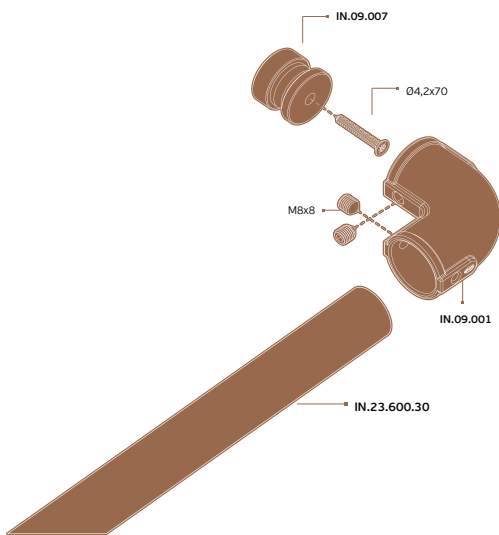
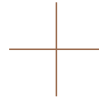
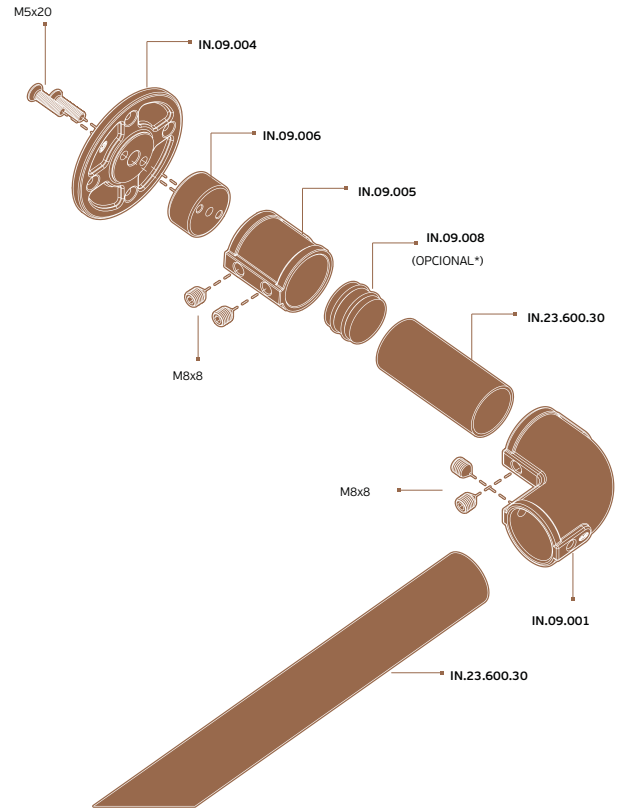
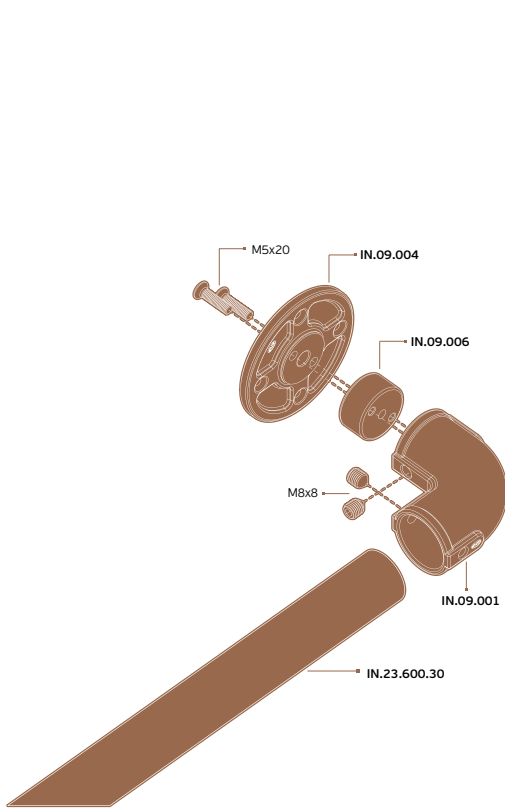

**UNLIMITED WORKSHOP  
HARDWARE**



---

**J. NEVES & FILHOS**

**COMÉRCIO E INDÚSTRIA DE FERRAGENS, S.A.**

Rua das Mimosas, 849/851 Zona Industrial das Mimosas  
S. Pedro da Cova | Ap. 75 4424-909 Gondomar PORTUGAL  
T. (+351) 224 663 230 | F. (+351) 224 8  
[jnf@jnf.pt](mailto:jnf@jnf.pt) | [www.jnf.pt](http://www.jnf.pt)

---

**AS ESPECIFICAÇÕES DOS PRODUTOS CONTIDOS NESTES  
CATÁLOGOS PODEM SER ALTERADOS SEM AVISO PRÉVIO.**

The technical specifications of the products contents in this catalogue can be changed without any previous advise.

Las especificaciones técnicas de los productos contenidos en este catalogo pueden ser cambiadas sin previo aviso.

**A REPRODUÇÃO INTEGRAL OU PARCIAL DESTE CATÁLOGO NÃO  
É PERMITIDA.**

The integral or partial copy of this catalogue is not allowed. La copia integral o parcial deste catalogo no es permitida.

**O PRESENTE CATÁLOGO NÃO SEGUE AS REGRAS DO NOVO  
ACORDO ORTOGRÁFICO.**

**TODAS AS MEDIDAS DESTE CATÁLOGO ESTÃO EM MILÍMETROS.**

All the dimensions in this catalogue are in milimeters.

Todas las dimensiones en este catalogo estan en milímetros.

Aos valores apresentados acresce o IVA à taxa legal em vigor.

**CT-17.3.0**

WWW.JNF.PT

**ALWAYS  
MORE**

